

The logo for SHW, consisting of the letters 'SHW' in white on an orange trapezoidal background.

**MAKING
PROPERTY
WORK**
SHW.CO.UK



TO LET

WAREHOUSE – FROM 965 – 3,351 SQ FT (89.65 – 311.32 SQ M)

Mayes Lane Business Park, Mayes Lane, Warnham, Horsham, West Sussex, RH12 3ZF

DESCRIPTION

6 employment space units of 1,000 and 1,500 sq ft, built totalling 8,000 sq ft.

The site is a development by Mayes Lane Ltd.

LOCATION

The units are situated off Mayes Lane via a separate access to Cider Mill Farm. The property is located to the north west of 1 and 2 Cider Mill Farm Cottage.

The A24 is approximately 0.6 miles from the subject property. London Gatwick Airport is approximately 15 miles away.

ACCOMMODATION (GROSS EXTERNAL AREA)

	SQ FT	SQ M	
Unit 1	1,460	135.64	Let
Unit 2	1,460	135.64	Let
Unit 3	1,264	117.46	Available
Unit 4	965	89.64	Available
Unit 5	960	89.15	Let
Unit 6	1,122	104.19	Available
TOTAL	7,231	671.72	

WORKING HOUR RESTRICTIONS

Monday – Friday: 07.30 – 18.30

Saturday: 08.00 – 16.00

No working on Sunday or bank holidays.

AMENITIES

- Workshops (class B1) and storage (class B8)
- 3 phase power
- Fibre
- Individual meters
- 2 parking spaces per unit with capability for communal visitor parking
- Metal clad roof and Solar panels on the roof
- Building reclad with grey box profile sheeting
- Located 560m north of the built up area boundary of Warnham
- WC accommodation
- Secure gated access

RATES

To be assessed.

VAT

VAT will be charged on the quoting terms.

LEGAL COSTS

Each party is to be responsible for their own legal fees.

EPC

To be assessed.

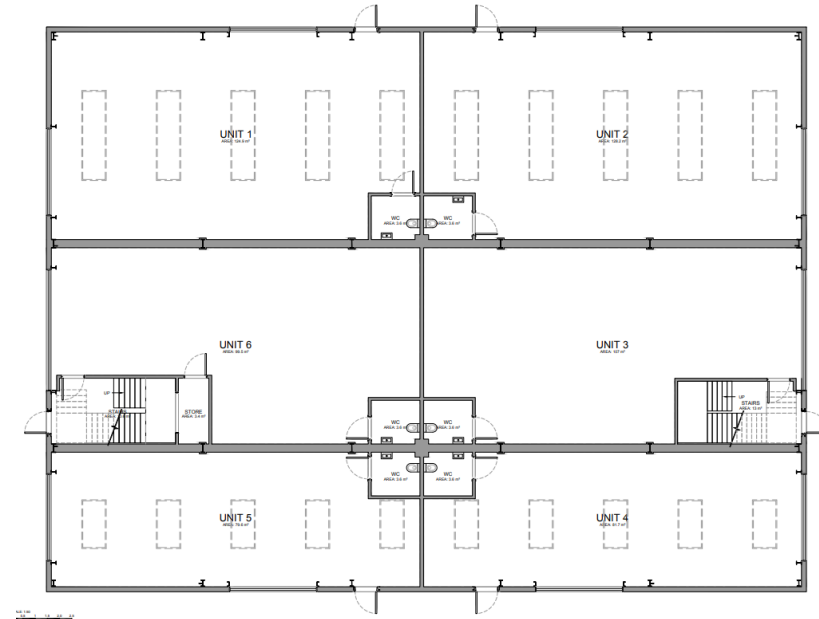

VIEWINGS – 01293 441300

Laura Miles

t: 07947 373275

e: lmiles@shw.co.uk

James Clement

t: 07961 231 286

e: jclement@shw.co.uk



twitter - @SHWProperty



LinkedIn - SHW Property



Instagram – SHW Property

**MAKING
PROPERTY
WORK**