

The logo for SHW, consisting of the letters 'SHW' in white on an orange trapezoidal background.

**MAKING
PROPERTY
WORK**

SHW.CO.UK



TO LET

LAND / OPEN STORAGE – 5,062 SQ FT (470.26 SQ M)

Arches & Land North Of, 94 Angel Road, Thames Ditton, Surrey, KT7 0BA

DESCRIPTION

Open storage / land available to lease. The land measures approximately 5,062 sq ft and we have been advised that there is an electricity supply available. The land is grass surface and would be suitable for storage and other purposes (STNC).

LOCATION

The land is located in Angel Road, Thames Ditton and conveniently located 0.7 miles from the Kingston Bypass and 1.8 Miles from Surbiton Train Station.

SIZE

	SQ FT	SQ M
Land	5,062	470.26

AMENITIES / OPPORTUNITY

- Open storage land.
- Securely fenced with electricity supply.
- Well positioned near Surbiton Train Station and the Kingston Bypass.

RENT

£14,000 PAX

RATES

Rateable value to be assessed.

VAT

VAT will be chargeable on the terms quoted.

EPC

An EPC is being prepared and will be available shortly.

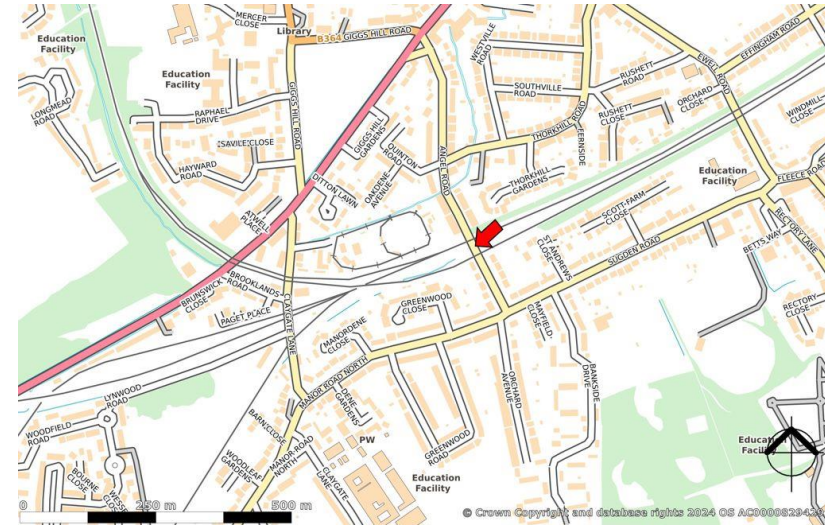

VIEWINGS – 01273 876200

Alexander Denning

t: 01273 876 218

e: adenning@shw.co.uk

Matt Morris

t: 020 8662 2732

e: mmorris@shw.co.uk



@SHWProperty



SHW Property



SHW Property

**MAKING
PROPERTY
WORK**

SHW.CO.UK

SHW prepares sales and letting particulars diligently and all reasonable steps are taken to ensure that they are correct. Neither a seller nor a landlord nor SHW will, however, be under any liability to any purchaser or tenant or prospective purchaser or tenant in respect of them. If a property is unoccupied, SHW may not have all the information required by a prospective purchaser or tenant in its possession, may not be able to obtain it and may not be able to verify all the information which it does hold. The mention of appliances and/or services or heating/cooling system or any other plant or fanestration systems in this description does not imply that they are in working order. Prospective purchasers should make their own investigations before finalising any agreement to purchase or lease. Note: Any maps or plans included in this document are obtained from Promap or Edozo under our Ordnance Survey Business Use Copyright licence ES 100017692 or are Goia Digital Plans including mapping data licensed from Ordnance Survey Crown Copyright 2007 under licence number PU 100017316

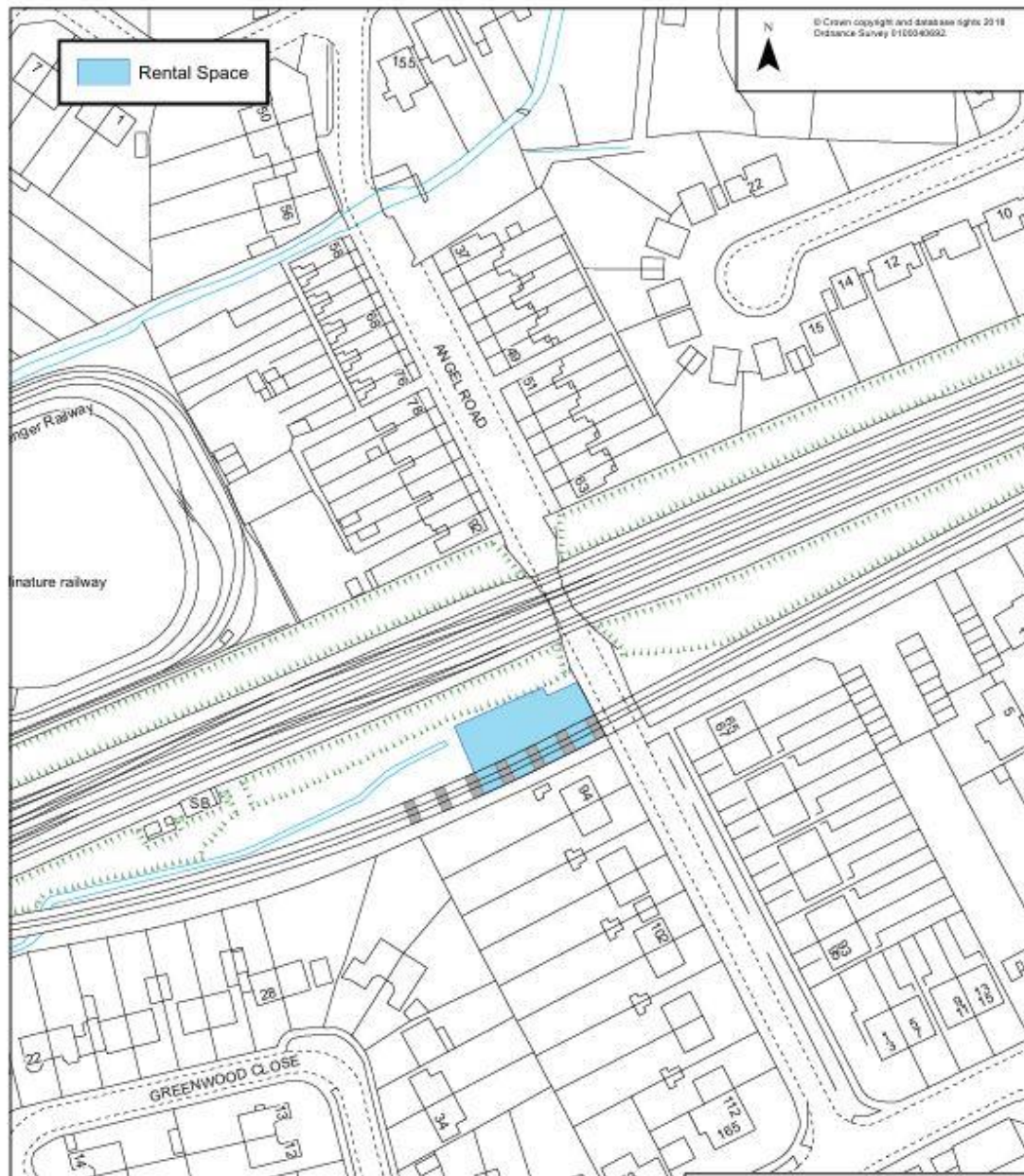

VIEWINGS – 01273 876200

Alexander Denning

t: 01273 876 218

e: adenning@shw.co.uk

Matt Morris

t: 020 8662 2732

e: mmorris@shw.co.uk



@SHWProperty



SHW Property



SHW Property